

# UNBLOCKING LINE PAINTER PENS

IT IS REALLY IMPORTANT TO REPLACE THE CAP ON YOUR PENS OTHERWISE YOU RISK DAMAGING THE NIB.

DUE TO THE PERMANENT NATURE OF THE INK ONCE DRY, IF THE INK IS ALLOWED TO DRY ON THE NIB, IT MAY BECOME BLOCKED.

STEPS TO TRY, TO UNBLOCK YOUR NIB:



**WARNING!**



1. SHAKE THE PEN VIGOROUSLY WITH CAP ON.



2. TRY PEN AGAIN, DRAW LOTS OF LINES.

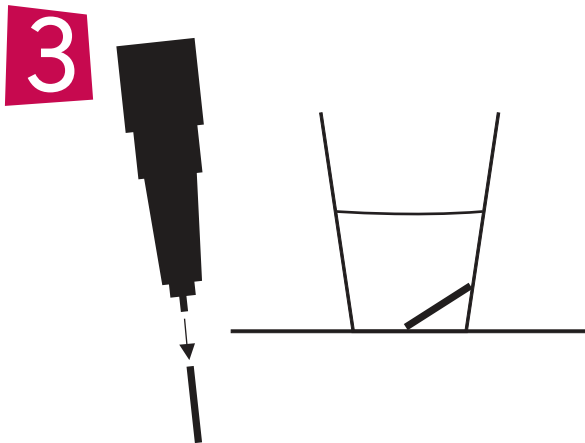

3. REMOVE NIB (JUST PULL) AND SOAK IN A GLASS OF WARM WATER.

ALLOW TO DRY THEN REPLACE NIB AND TRY AGAIN.

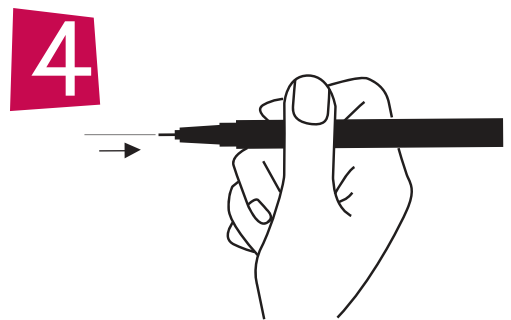

4. TAKE A FINE PIN AND PIERCE THE END OF THE NIB WITH FINE PIN.

